

Steering Column

Removal

CAUTION:

- All SRS wiring harnesses are covered with yellow outer insulation.
- Before disconnecting any part of the SRS wire harness, install the short connectors (see page 23-407).
- Replace the entire affected SRS harness assembly if it has an open circuit or damaged wiring.

1. Remove the driver's airbag assembly and steering wheel (see page 17-22).
2. Remove the steering joint bolt, (in the engine compartment.)

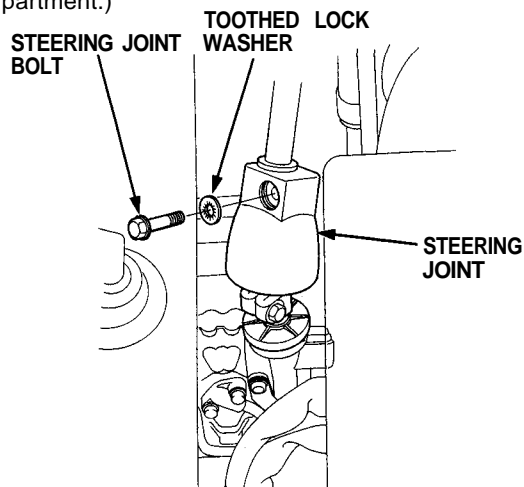

3. Remove the courtesy light control switch and disconnect the connector, then remove the dashboard lower panel.

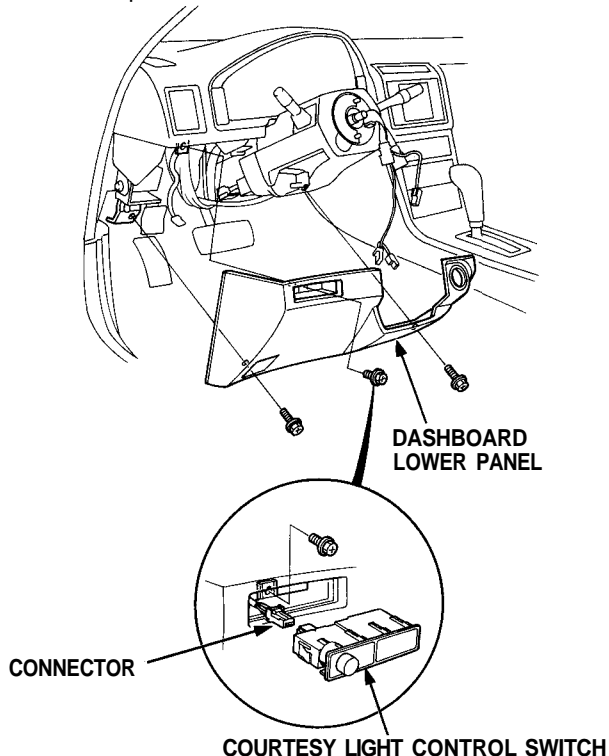

4. Remove the upper and lower column covers.

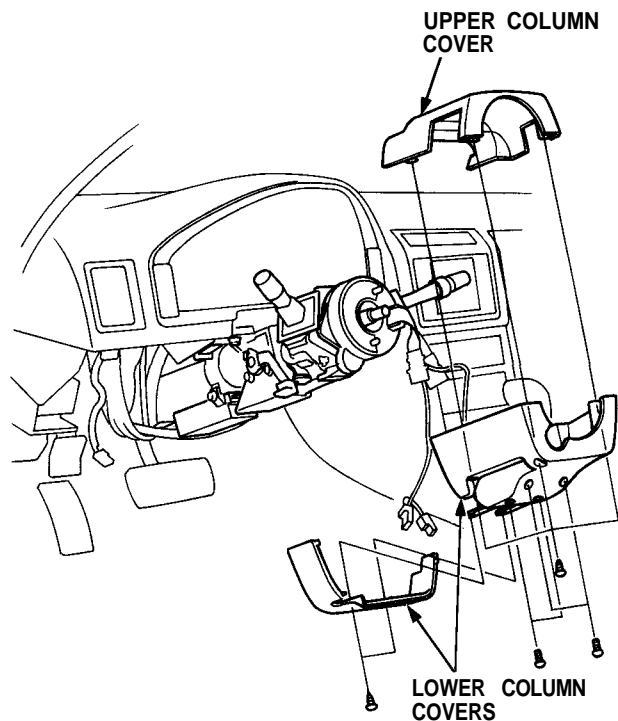

5. Remove the steering joint cover.

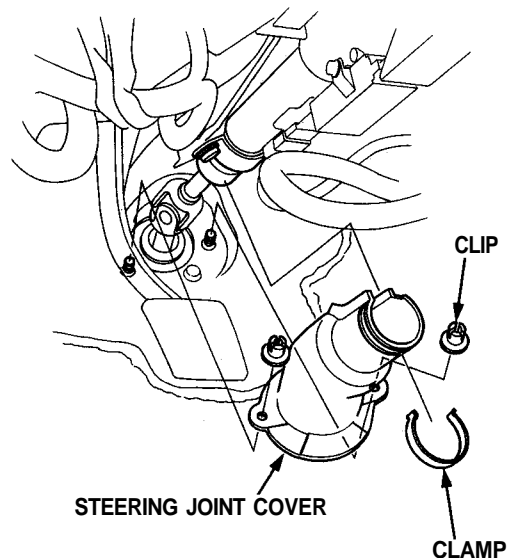



6. Remove the cable reel box from the underside of the column pipe.

7. Remove the connector holder.

CAUTION: Do not disconnect the cable reel connector and the SRS wire harness. After removing the cable reel box, place it on the car floor.

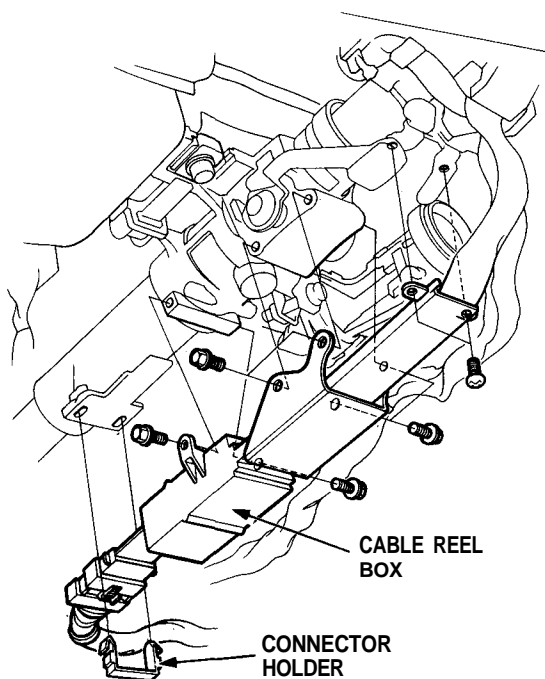

8. Remove the cable reel, turn signal canceling sleeve and combination switch from the column shaft.

NOTE: After removing the combination switch assembly, place it on the floor gently. Do not disconnect the cables from the combination switch.

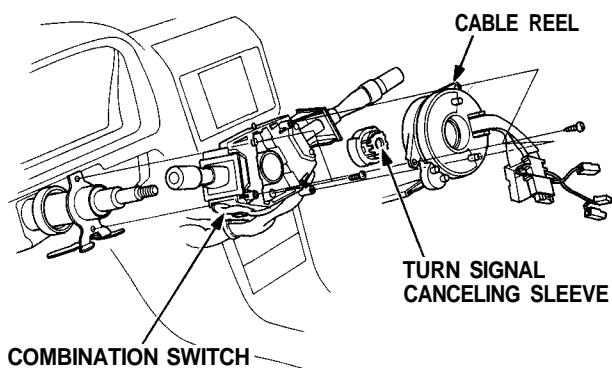

9. Disconnect the ignition switch connector from the under-dash fuse/relay box.

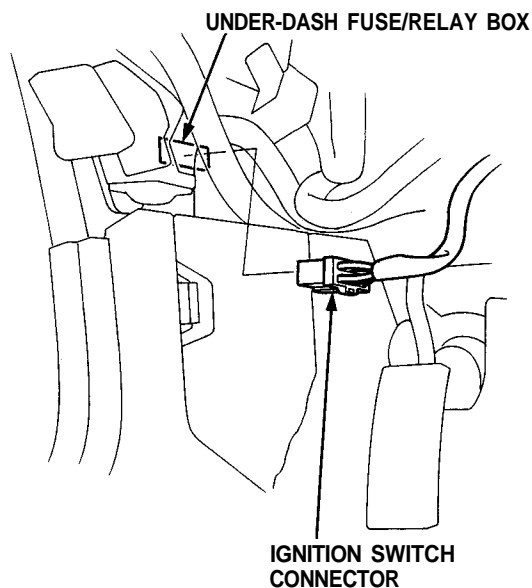

10. Remove the steering column assembly by removing the attaching nuts and bolts.

